

# Accessories

## Accessories at a glance

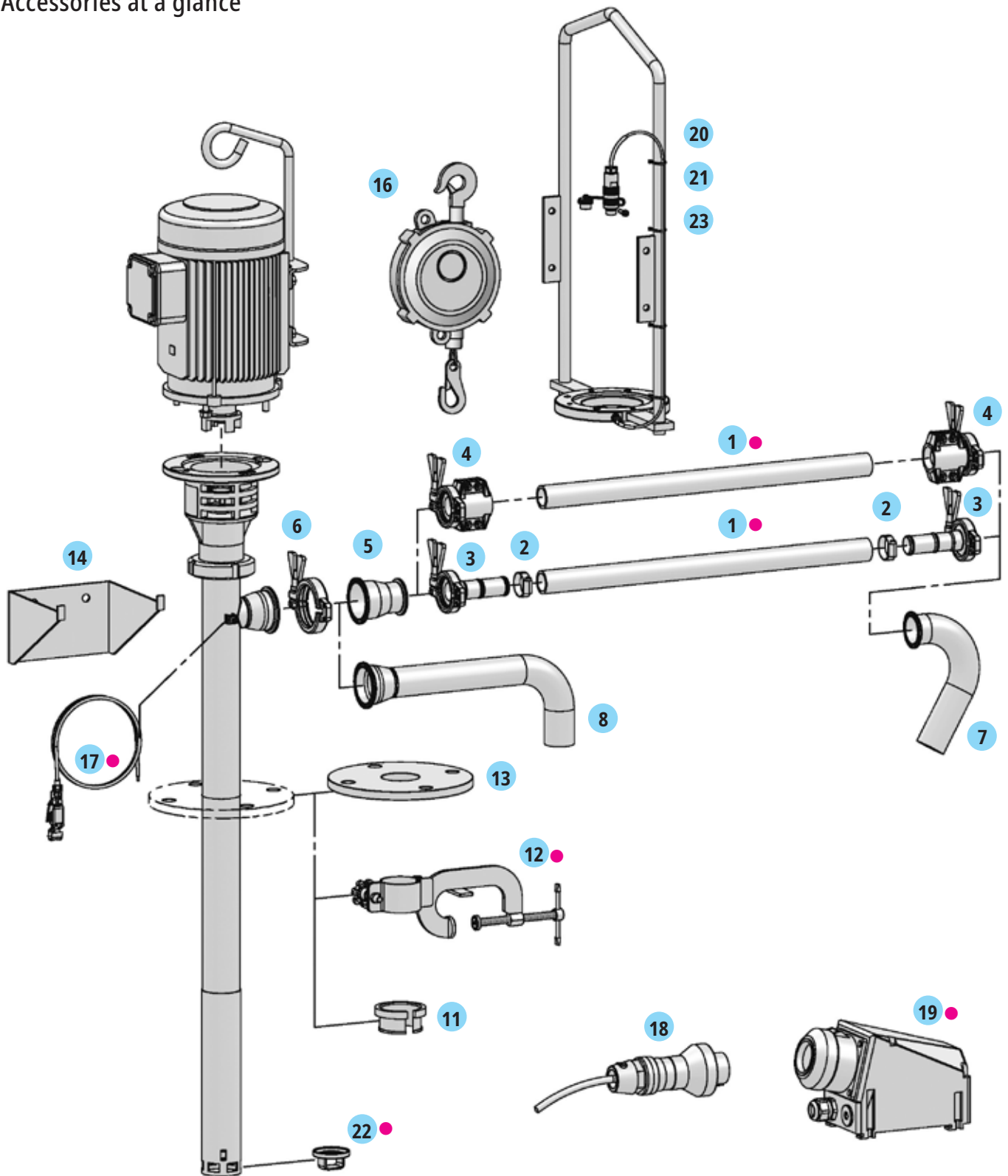

- |                                     |   |  |
|-------------------------------------|---|--|
| <b>1</b> ● Hose                     | <b>8</b> ● Discharge spout              | <b>18</b> ● Ex-plug                            |
| <b>2</b> ● Hose clip                | <b>11</b> ● Drum adapter                | <b>19</b> ● Ex-socket                          |
| <b>3</b> ● Hose connection          | <b>12</b> ● Clamping device             | <b>20</b> ● Lifting device                     |
| <b>4</b> ● Hose connector           | <b>13</b> ● Installation flange         | <b>21</b> ● Impulse transmitter                |
| <b>5</b> ● Tri-Clamp reducing piece | <b>14</b> ● Wall bracket                | <b>22</b> ● Protection device for drum inliner |
| <b>6</b> ● Tri-Clamp locking clamp  | <b>16</b> ● Balancer                    | <b>23</b> ● Operating unit                     |
| <b>7</b> ● Discharge spout          | <b>17</b> ● Equipotential bonding cable |  |

● Suitable for transferring combustible and easy flammable liquids (e.g. ethanol, petrol) or in explosive hazard area.

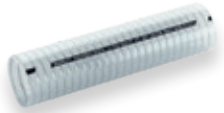
Specification	Order-No.	Product detail								
<p><b>1 PVC spiral hose, fabric reinforced</b></p> <p>Hose for food liquids made of PVC with woven layer and imbedded galvanized steel helix, inside and outside smooth, complies with EU-regulations 10/2011 and 1935/2004.</p> <p>Operating pressure: max. 14 bar            Temperature of medium: -5 °C up to +65 °C            Nominal diameter: Weight:</p> <table style="width: 100%; border-collapse: collapse;"> <tr> <td style="width: 50%;">DN 25 (1")</td> <td style="width: 50%;">0.67 kg/m</td> </tr> <tr> <td>DN 32 (1 1/4")</td> <td>0.80 kg/m</td> </tr> <tr> <td>DN 38 (1 1/2")</td> <td>1.15 kg/m</td> </tr> <tr> <td>DN 50 (2")</td> <td>1.60 kg/m</td> </tr> </table>	DN 25 (1")	0.67 kg/m	DN 32 (1 1/4")	0.80 kg/m	DN 38 (1 1/2")	1.15 kg/m	DN 50 (2")	1.60 kg/m	<p><b>0374-467</b>  <b>0374-468</b>  <b>0374-469</b>  <b>0374-470</b></p>	
DN 25 (1")	0.67 kg/m									
DN 32 (1 1/4")	0.80 kg/m									
DN 38 (1 1/2")	1.15 kg/m									
DN 50 (2")	1.60 kg/m									
<p><b>1 Universal chemical hose</b></p> <p>Colour coding: "blue/white/blue".            Suitable for food and luxury foodstuffs, pharmaceuticals, cosmetics and hygiene products. Conform to FDA and USP class VI. Complies with EU-regulations 10/2011 and 1935/2004.            Internal finish: UPE light with spiraled OHM conductive stripes UPE black, smooth, non-bleeding, abrasion-resistant.            Intermediate layer: EPDM conductive (complies with the requirements of the recommendation XXI category 2 of the BfR and FDA standards).            External finish: EPDM light grey, conductive, non-bleeding, ozone- and UV resistant, hardly flammable, (starting from DN 25 with galvanized steel helix, suitable as suction and pressure hose).            Electrically conductive: Type Ω/T (&lt;10<sup>6</sup> Ohm between the fittings, &lt;10<sup>9</sup> Ohm through the hose wall) according to DIN EN 12115:2011.</p> <p>Operating pressure: max. 16 bar            Temperature of medium: -30 up to +100 °C (dependant on the liquid), sterilisable at 130 °C for 30 minutes (open ends)</p> <p>Nominal diameter: Weight:</p> <table style="width: 100%; border-collapse: collapse;"> <tr> <td style="width: 50%;">DN 25 (1")</td> <td style="width: 50%;">0.8 kg/m</td> </tr> <tr> <td>DN 32 (1 1/4")</td> <td>0.9 kg/m</td> </tr> <tr> <td>DN 38 (1 1/2")</td> <td>1.2 kg/m</td> </tr> <tr> <td>DN 50 (2")</td> <td>1.9 kg/m</td> </tr> </table>	DN 25 (1")	0.8 kg/m	DN 32 (1 1/4")	0.9 kg/m	DN 38 (1 1/2")	1.2 kg/m	DN 50 (2")	1.9 kg/m	<p><b>0374-476 ●</b>  <b>0374-477 ●</b>  <b>0374-478 ●</b>  <b>0374-479 ●</b></p>	
DN 25 (1")	0.8 kg/m									
DN 32 (1 1/4")	0.9 kg/m									
DN 38 (1 1/2")	1.2 kg/m									
DN 50 (2")	1.9 kg/m									
<p><b>2 Hose clips</b></p> <p>Stainless steel hose clips with threaded screw for fixing hoses of various nominal bore at the hose connection.</p> <p>Nominal diameter:</p> <table style="width: 100%; border-collapse: collapse;"> <tr> <td style="width: 50%;">DN 25 (1")</td> <td style="width: 50%;"></td> </tr> <tr> <td>DN 32 - 38 (1 1/4" - 1 1/2")</td> <td></td> </tr> <tr> <td>DN 50 (2")</td> <td></td> </tr> </table>	DN 25 (1")		DN 32 - 38 (1 1/4" - 1 1/2")		DN 50 (2")		<p><b>0301-401</b>  <b>0302-402</b>  <b>0302-403</b></p>			
DN 25 (1")										
DN 32 - 38 (1 1/4" - 1 1/2")										
DN 50 (2")										

# Accessories

For B70V SanitaryPlus and B70 PURE

Product detail	Specification	Order-No.																																																																														
 <p><b>Caution:</b> The assembler is responsible for the professional bonding of the hose according to the current Pressure Equipment Directive.</p>	<p><b>3 Hose connection with Tri-Clamp</b> For connection of the hose onto the eccentric screw pump B70, discharge spout or Tri-clamp armatures (consisting of hose connector, locking clamp and seal) Material: Stainless steel (1.4404)</p> <table border="0"> <tr> <td>Connection:</td> <td colspan="2">for hose with nominal diameter:Seal:</td> <td></td> </tr> <tr> <td>Tri-Clamp DN 32**</td> <td>DN 19 (3/4")</td> <td>EPDM</td> <td><b>0204-870</b></td> </tr> <tr> <td>Tri-Clamp DN 32**</td> <td>DN 19 (3/4")</td> <td>FPM</td> <td><b>0204-871</b></td> </tr> <tr> <td>Tri-Clamp DN 32**</td> <td>DN 25 (1")</td> <td>EPDM</td> <td><b>0204-872</b></td> </tr> <tr> <td>Tri-Clamp DN 32**</td> <td>DN 25 (1")</td> <td>FPM</td> <td><b>0204-873</b></td> </tr> <tr> <td>Tri-Clamp DN 32**</td> <td>DN 32 (1 1/4")</td> <td>EPDM</td> <td><b>0204-874</b></td> </tr> <tr> <td>Tri-Clamp DN 32**</td> <td>DN 32 (1 1/4")</td> <td>FPM</td> <td><b>0204-875</b></td> </tr> <tr> <td>Tri-Clamp DN 32**</td> <td>DN 38 (1 1/2")</td> <td>EPDM</td> <td><b>0204-876</b></td> </tr> <tr> <td>Tri-Clamp DN 32**</td> <td>DN 38 (1 1/2")</td> <td>FPM</td> <td><b>0204-877</b></td> </tr> <tr> <td>Tri-Clamp DN 50</td> <td>DN 38 (1 1/2")</td> <td>EPDM</td> <td><b>0172-746</b></td> </tr> <tr> <td>Tri-Clamp DN 50</td> <td>DN 38 (1 1/2")</td> <td>FPM</td> <td><b>0204-878</b></td> </tr> <tr> <td>Tri-Clamp DN 50</td> <td>DN 50 (2")</td> <td>EPDM</td> <td><b>0204-879</b></td> </tr> <tr> <td>Tri-Clamp DN 50</td> <td>DN 50 (2")</td> <td>FPM</td> <td><b>0204-880</b></td> </tr> </table> <p><b>For individual needs, e.g. for connection to on-site Tri-clamp armatures:</b></p> <p><b>Tri-clamp hose connector (1.4404):</b></p> <table border="0"> <tr> <td>DN 32 for hose DN 19</td> <td><b>0370-093</b></td> </tr> <tr> <td>DN 32 for hose DN 25</td> <td><b>0370-094</b></td> </tr> <tr> <td>DN 32 for hose DN 32</td> <td><b>0370-095</b></td> </tr> <tr> <td>DN 32 for hose DN 38</td> <td><b>0370-096</b></td> </tr> <tr> <td>DN 50 for hose DN 50</td> <td><b>0370-097</b></td> </tr> </table> <p><b>Tri-clamp locking clamp (1.4408):</b></p> <table border="0"> <tr> <td>DN 25/32/40</td> <td><b>0370-088</b></td> </tr> <tr> <td>DN 50</td> <td><b>0370-084</b></td> </tr> </table> <p><b>Tri-Clamp Seals:</b></p> <table border="0"> <tr> <td>DN 32, EPDM</td> <td><b>0314-596</b></td> </tr> <tr> <td>DN 32, FPM</td> <td><b>0314-597</b></td> </tr> <tr> <td>DN 40, EPDM</td> <td><b>0314-598</b></td> </tr> <tr> <td>DN 40, FPM</td> <td><b>0314-599</b></td> </tr> <tr> <td>DN 50, EPDM</td> <td><b>0314-590</b></td> </tr> <tr> <td>DN 50, FPM</td> <td><b>0314-591</b></td> </tr> </table> <p>** If using for eccentric screw pumps B70 an additional reducing piece DN 50 to DN 25/32/40 (Item 5) and a locking clamp (Item. 6) are required.</p>	Connection:	for hose with nominal diameter:Seal:			Tri-Clamp DN 32**	DN 19 (3/4")	EPDM	<b>0204-870</b>	Tri-Clamp DN 32**	DN 19 (3/4")	FPM	<b>0204-871</b>	Tri-Clamp DN 32**	DN 25 (1")	EPDM	<b>0204-872</b>	Tri-Clamp DN 32**	DN 25 (1")	FPM	<b>0204-873</b>	Tri-Clamp DN 32**	DN 32 (1 1/4")	EPDM	<b>0204-874</b>	Tri-Clamp DN 32**	DN 32 (1 1/4")	FPM	<b>0204-875</b>	Tri-Clamp DN 32**	DN 38 (1 1/2")	EPDM	<b>0204-876</b>	Tri-Clamp DN 32**	DN 38 (1 1/2")	FPM	<b>0204-877</b>	Tri-Clamp DN 50	DN 38 (1 1/2")	EPDM	<b>0172-746</b>	Tri-Clamp DN 50	DN 38 (1 1/2")	FPM	<b>0204-878</b>	Tri-Clamp DN 50	DN 50 (2")	EPDM	<b>0204-879</b>	Tri-Clamp DN 50	DN 50 (2")	FPM	<b>0204-880</b>	DN 32 for hose DN 19	<b>0370-093</b>	DN 32 for hose DN 25	<b>0370-094</b>	DN 32 for hose DN 32	<b>0370-095</b>	DN 32 for hose DN 38	<b>0370-096</b>	DN 50 for hose DN 50	<b>0370-097</b>	DN 25/32/40	<b>0370-088</b>	DN 50	<b>0370-084</b>	DN 32, EPDM	<b>0314-596</b>	DN 32, FPM	<b>0314-597</b>	DN 40, EPDM	<b>0314-598</b>	DN 40, FPM	<b>0314-599</b>	DN 50, EPDM	<b>0314-590</b>	DN 50, FPM	<b>0314-591</b>	
Connection:	for hose with nominal diameter:Seal:																																																																															
Tri-Clamp DN 32**	DN 19 (3/4")	EPDM	<b>0204-870</b>																																																																													
Tri-Clamp DN 32**	DN 19 (3/4")	FPM	<b>0204-871</b>																																																																													
Tri-Clamp DN 32**	DN 25 (1")	EPDM	<b>0204-872</b>																																																																													
Tri-Clamp DN 32**	DN 25 (1")	FPM	<b>0204-873</b>																																																																													
Tri-Clamp DN 32**	DN 32 (1 1/4")	EPDM	<b>0204-874</b>																																																																													
Tri-Clamp DN 32**	DN 32 (1 1/4")	FPM	<b>0204-875</b>																																																																													
Tri-Clamp DN 32**	DN 38 (1 1/2")	EPDM	<b>0204-876</b>																																																																													
Tri-Clamp DN 32**	DN 38 (1 1/2")	FPM	<b>0204-877</b>																																																																													
Tri-Clamp DN 50	DN 38 (1 1/2")	EPDM	<b>0172-746</b>																																																																													
Tri-Clamp DN 50	DN 38 (1 1/2")	FPM	<b>0204-878</b>																																																																													
Tri-Clamp DN 50	DN 50 (2")	EPDM	<b>0204-879</b>																																																																													
Tri-Clamp DN 50	DN 50 (2")	FPM	<b>0204-880</b>																																																																													
DN 32 for hose DN 19	<b>0370-093</b>																																																																															
DN 32 for hose DN 25	<b>0370-094</b>																																																																															
DN 32 for hose DN 32	<b>0370-095</b>																																																																															
DN 32 for hose DN 38	<b>0370-096</b>																																																																															
DN 50 for hose DN 50	<b>0370-097</b>																																																																															
DN 25/32/40	<b>0370-088</b>																																																																															
DN 50	<b>0370-084</b>																																																																															
DN 32, EPDM	<b>0314-596</b>																																																																															
DN 32, FPM	<b>0314-597</b>																																																																															
DN 40, EPDM	<b>0314-598</b>																																																																															
DN 40, FPM	<b>0314-599</b>																																																																															
DN 50, EPDM	<b>0314-590</b>																																																																															
DN 50, FPM	<b>0314-591</b>																																																																															
	<p><b>3 Adapter fitting Tri-Clamp</b></p> <table border="0"> <tr> <td>DN 32 on tube fitting DIN 11851 Rd 58 x 1/6 (DIN 405)</td> <td><b>0172-668</b></td> </tr> <tr> <td>DN 50 on tube fitting DIN 11851 Rd 78 x 1/6 (DIN 405)</td> <td><b>0172-747</b></td> </tr> </table>	DN 32 on tube fitting DIN 11851 Rd 58 x 1/6 (DIN 405)	<b>0172-668</b>	DN 50 on tube fitting DIN 11851 Rd 78 x 1/6 (DIN 405)	<b>0172-747</b>																																																																											
DN 32 on tube fitting DIN 11851 Rd 58 x 1/6 (DIN 405)	<b>0172-668</b>																																																																															
DN 50 on tube fitting DIN 11851 Rd 78 x 1/6 (DIN 405)	<b>0172-747</b>																																																																															



Specification	Order-No.	Product detail																																												
<p><b>4 Hose connector with Tri-clamp</b></p> <p>For connection of conductive hose onto the eccentric screw pump B70, discharge spout or Tri-Clamp armatures in explosive hazardous area. The hose connector ensures a highly conduction transition between conductive hose and pump/armature. The ohmic resistance between the armatures must be lower than 10<sup>6</sup> Ohm. (Consisting of hose connector, clamp collars, locking clamp and seal) Material: Stainless steel (1.4404)</p>																																														
																																														
<p>Connection:</p> <table border="0"> <tr> <td>Tri-Clamp DN 32**</td> <td>for hose Nominal diameter:</td> <td>Seal:</td> <td><b>0204-860</b> ●</td> </tr> <tr> <td>Tri-Clamp DN 32**</td> <td>DN 19 (3/4")</td> <td>EPDM</td> <td><b>0204-861</b> ●</td> </tr> <tr> <td>Tri-Clamp DN 32**</td> <td>DN 19 (3/4")</td> <td>FPM</td> <td><b>0204-862</b> ●</td> </tr> <tr> <td>Tri-Clamp DN 32**</td> <td>DN 25 (1")</td> <td>EPDM</td> <td><b>0204-863</b> ●</td> </tr> <tr> <td>Tri-Clamp DN 32**</td> <td>DN 25 (1")</td> <td>FPM</td> <td><b>0204-864</b> ●</td> </tr> <tr> <td>Tri-Clamp DN 32**</td> <td>DN 32 (1 1/4")</td> <td>EPDM</td> <td><b>0204-865</b> ●</td> </tr> <tr> <td>Tri-Clamp DN 32**</td> <td>DN 32 (1 1/4")</td> <td>FPM</td> <td><b>0204-866</b> ●</td> </tr> <tr> <td>Tri-Clamp DN 40**</td> <td>DN 38 (1 1/2")</td> <td>EPDM</td> <td><b>0204-867</b> ●</td> </tr> <tr> <td>Tri-Clamp DN 40**</td> <td>DN 38 (1 1/2")</td> <td>FPM</td> <td><b>0204-868</b> ●</td> </tr> <tr> <td>Tri-Clamp DN 50</td> <td>DN 50 (2")</td> <td>EPDM</td> <td><b>0204-869</b> ●</td> </tr> <tr> <td>Tri-Clamp DN 50</td> <td>DN 50 (2")</td> <td>FPM</td> <td></td> </tr> </table>	Tri-Clamp DN 32**	for hose Nominal diameter:	Seal:	<b>0204-860</b> ●	Tri-Clamp DN 32**	DN 19 (3/4")	EPDM	<b>0204-861</b> ●	Tri-Clamp DN 32**	DN 19 (3/4")	FPM	<b>0204-862</b> ●	Tri-Clamp DN 32**	DN 25 (1")	EPDM	<b>0204-863</b> ●	Tri-Clamp DN 32**	DN 25 (1")	FPM	<b>0204-864</b> ●	Tri-Clamp DN 32**	DN 32 (1 1/4")	EPDM	<b>0204-865</b> ●	Tri-Clamp DN 32**	DN 32 (1 1/4")	FPM	<b>0204-866</b> ●	Tri-Clamp DN 40**	DN 38 (1 1/2")	EPDM	<b>0204-867</b> ●	Tri-Clamp DN 40**	DN 38 (1 1/2")	FPM	<b>0204-868</b> ●	Tri-Clamp DN 50	DN 50 (2")	EPDM	<b>0204-869</b> ●	Tri-Clamp DN 50	DN 50 (2")	FPM			
Tri-Clamp DN 32**	for hose Nominal diameter:	Seal:	<b>0204-860</b> ●																																											
Tri-Clamp DN 32**	DN 19 (3/4")	EPDM	<b>0204-861</b> ●																																											
Tri-Clamp DN 32**	DN 19 (3/4")	FPM	<b>0204-862</b> ●																																											
Tri-Clamp DN 32**	DN 25 (1")	EPDM	<b>0204-863</b> ●																																											
Tri-Clamp DN 32**	DN 25 (1")	FPM	<b>0204-864</b> ●																																											
Tri-Clamp DN 32**	DN 32 (1 1/4")	EPDM	<b>0204-865</b> ●																																											
Tri-Clamp DN 32**	DN 32 (1 1/4")	FPM	<b>0204-866</b> ●																																											
Tri-Clamp DN 40**	DN 38 (1 1/2")	EPDM	<b>0204-867</b> ●																																											
Tri-Clamp DN 40**	DN 38 (1 1/2")	FPM	<b>0204-868</b> ●																																											
Tri-Clamp DN 50	DN 50 (2")	EPDM	<b>0204-869</b> ●																																											
Tri-Clamp DN 50	DN 50 (2")	FPM																																												
<p><b>For individual needs, e.g. for connection to on-site Tri-clamp armatures:</b></p> <p><b>Tri-clamp hose connector (1.4404):</b></p> <table border="0"> <tr> <td>DN 32 for hose DN 19</td> <td><b>0300-174</b></td> </tr> <tr> <td>DN 32 for hose DN 25</td> <td><b>0300-175</b></td> </tr> <tr> <td>DN 32 for hose DN 32</td> <td><b>0300-176</b></td> </tr> <tr> <td>DN 40 for hose DN 38</td> <td><b>0300-177</b></td> </tr> <tr> <td>DN 50 for hose DN 50</td> <td><b>0300-178</b></td> </tr> </table> <p><b>Clamp collar (1.4408):</b></p> <table border="0"> <tr> <td>DN 19</td> <td><b>0300-180</b></td> </tr> <tr> <td>DN 25</td> <td><b>0300-181</b></td> </tr> <tr> <td>DN 32</td> <td><b>0300-182</b></td> </tr> <tr> <td>DN 38</td> <td><b>0300-183</b></td> </tr> <tr> <td>DN 50</td> <td><b>0300-184</b></td> </tr> </table> <p><b>Tri-Clamp locking clamp (1.4408):</b></p> <table border="0"> <tr> <td>DN 25/32/40</td> <td><b>0370-088</b></td> </tr> <tr> <td>DN 50</td> <td><b>0370-084</b></td> </tr> </table> <p><b>Tri-Clamp Seals:</b></p> <table border="0"> <tr> <td>DN 32, EPDM</td> <td><b>0314-596</b></td> </tr> <tr> <td>DN 32, FPM</td> <td><b>0314-597</b></td> </tr> <tr> <td>DN 40, EPDM</td> <td><b>0314-598</b></td> </tr> <tr> <td>DN 40, FPM</td> <td><b>0314-599</b></td> </tr> <tr> <td>DN 50, EPDM</td> <td><b>0314-590</b></td> </tr> <tr> <td>DN 50, FPM</td> <td><b>0314-591</b></td> </tr> </table>			DN 32 for hose DN 19	<b>0300-174</b>	DN 32 for hose DN 25	<b>0300-175</b>	DN 32 for hose DN 32	<b>0300-176</b>	DN 40 for hose DN 38	<b>0300-177</b>	DN 50 for hose DN 50	<b>0300-178</b>	DN 19	<b>0300-180</b>	DN 25	<b>0300-181</b>	DN 32	<b>0300-182</b>	DN 38	<b>0300-183</b>	DN 50	<b>0300-184</b>	DN 25/32/40	<b>0370-088</b>	DN 50	<b>0370-084</b>	DN 32, EPDM	<b>0314-596</b>	DN 32, FPM	<b>0314-597</b>	DN 40, EPDM	<b>0314-598</b>	DN 40, FPM	<b>0314-599</b>	DN 50, EPDM	<b>0314-590</b>	DN 50, FPM	<b>0314-591</b>								
DN 32 for hose DN 19	<b>0300-174</b>																																													
DN 32 for hose DN 25	<b>0300-175</b>																																													
DN 32 for hose DN 32	<b>0300-176</b>																																													
DN 40 for hose DN 38	<b>0300-177</b>																																													
DN 50 for hose DN 50	<b>0300-178</b>																																													
DN 19	<b>0300-180</b>																																													
DN 25	<b>0300-181</b>																																													
DN 32	<b>0300-182</b>																																													
DN 38	<b>0300-183</b>																																													
DN 50	<b>0300-184</b>																																													
DN 25/32/40	<b>0370-088</b>																																													
DN 50	<b>0370-084</b>																																													
DN 32, EPDM	<b>0314-596</b>																																													
DN 32, FPM	<b>0314-597</b>																																													
DN 40, EPDM	<b>0314-598</b>																																													
DN 40, FPM	<b>0314-599</b>																																													
DN 50, EPDM	<b>0314-590</b>																																													
DN 50, FPM	<b>0314-591</b>																																													
<p>** If using for eccentric screw pumps B70 an additional reducing piece DN 50 to DN 25/32/40 (Item 5) and a locking clamp (Item. 6) are required.</p>																																														

# Accessories

For B70V SanitaryPlus and B70 PURE

Product detail	Specification	Order-No.
	<p><b>5 Tri-Clamp reducing piece</b></p> <p>Suitable for connection of Tri-Clamp armatures DN 25/32/40 to a Tri-Clamp DN 50 connecting piece. Material: Stainless steel (1.4408)</p> <p>DN 50 onto DN 25/32/40</p>	<b>0300-185</b> ●
	<p><b>6 Tri-Clamp locking clamp</b></p> <p>Suitable for connection of armatures DN 50 to a connecting piece DN 50. Material: Stainless steel (1.4408) incl. seal.</p> <p>DN 50, Seal EPDM DN 50, Seal FPM</p>	<b>0172-745</b> ● <b>0204-477</b> ●
	<p><b>7 Discharge spout</b></p> <p>For mounting at the end of the hose for direct filling and transferring in containers incl. seal and clamp. Material: Stainless steel (1.4301/EPDM)</p> <p>Tri-Clamp DN 32 Tri-Clamp DN 40</p>	<b>0370-098</b> ● <b>0370-099</b> ●
	<p><b>8 Discharge spout</b></p> <p>For mounting at the end of the hose for direct filling and transferring in containers incl. seal and clamp. Material: Stainless steel (1.4571. 1.4404/EPDM).</p> <p>Tri-Clamp DN 50</p>	<b>0172-748</b> ●
	<p><b>22 Protection device for drum inliner</b></p> <p>For mounting onto the pump foot. Protects sensitive drum inliner and bags from damage.</p> <p>For pump tube B70V-H SanitaryPlus For pump tube B70V 120.1</p>	<b>0173-819</b> ● <b>0175-332</b>
	<p><b>11 Drum adapter in PP</b></p> <p>For fixing the eccentric screw pump B70 in the drum opening. For pump tube <math>\varnothing</math> 52-54 mm Universal for all current drum and bunghole openings</p>	<b>0208-056</b>
	<p><b>12 Clamping device SS (1.4571)</b></p> <p>To fasten the eccentric screw pump B70 in open-topped drums and containers. For pump tube <math>\varnothing</math> 52-54 mm</p>	<b>0205-052</b> ●
	<p><b>13 Installation flange SS (1.4571)</b></p> <p>For fixing the eccentric screw pump B70 according to DIN 2573, DN 50, PN 6, to a companion flange. The flange is welded onto the pump tube. For pump tube <math>\varnothing</math> 52-54 mm</p>	<b>0170-310</b>
	<p><b>14 Wall bracket</b></p> <p>For safe storage of the eccentric screw pump B70 when not in use.</p> <p>for B70V for B70V-SR</p>	<b>0204-309</b> <b>0204-307</b>

● Suitable for transferring combustible and easy flammable liquids (e.g. ethanol, petrol) or in explosive hazard area.

Specification	Order-No.	Product detail
<p><b>16 Balancer</b> for eccentric screw pumps, with infinitely adjustable load balancer for easy lifting and moving of the pump</p> <p>Load bearing capacity: 18-22 kg Load bearing capacity: 22-25 kg Load bearing capacity: 25-30 kg</p> <p>Tackle: 2 m Tackle: 2 m Tackle: 2 m</p>	<p><b>0371-013</b> <b>0371-014</b> <b>0371-015</b></p>	
<p><b>17 Equipotential bonding cable</b> Serves to create electrically conductive connection between explosion proof pump and container as earthing and equipotential bonding function.</p> <p>2 m long with fastening clip 2 m long with two fastening clips</p> <p>for B70V-H Sanitary</p>	<p><b>0204-994</b> ● <b>0204-992</b> ●</p>	
<p><b>18 Ex-plug</b> Ensures the safe mains connection of the pump in explosive hazardous areas. CEE round plug in accordance with EEx de IIC T6, splash proof in compliance with IP 65.</p> <p>3-pole (alternating current) CEAG for B70V-SR (Ex) 3-pole (alternating current) STAHL for B70V-SR (Ex) 5-pole (three phase current) CEAG for B70V (Ex) 5-pole (three phase current) STAHL for B70V (Ex)</p>	<p><b>0336-536</b> ● <b>0336-540</b> ● <b>0336-537</b> ● <b>0336-541</b> ●</p>	
<p><b>19 Ex-socket</b> Ensures the safe mains connection of the pump in explosive hazardous areas. CEE-socket in accordance with EEx de IIC T6, splash proof in compliance with IP 65.</p> <p>3-pole (alternating current) CEAG for B70V-SR (Ex) 3-pole (alternating current) STAHL for B70V-SR (Ex) 5-pole (three phase current) CEAG for B70V (Ex) 5-pole (three phase current) STAHL for B70V (Ex)</p>	<p><b>0336-531</b> ● <b>0336-542</b> ● <b>0336-420</b> ● <b>0336-543</b> ●</p>	
<p><b>23 Motor protective switch for motor B70V (Ex)</b> Explosion proof according to EEx de IIC T6 with thermal and electromagnetic trip, protection type IP 66. A lifting device and two cable protective coverings are necessary for the mounting.</p> <p>Ex, 1.6 - 2.5 A Ex, 2.5 - 4.0 A Ex, 4.0 - 6.3 A</p>	<p><b>0335-414</b> ● <b>0335-419</b> ● <b>0335-420</b> ●</p>	
<p><b>18 Coupling part, motor side</b> When sourcing your own motor please order the correct coupling to suit the relative shaft diameter.</p> <p>Shaft diameter:      ø 14 mm                                   ø 19 mm                                   ø 24 mm                                   ø 28 mm (only in combination with intermediate flange)</p> <p>Intermediate flange for   ø 28 mm</p>	<p><b>0302-028</b> <b>0302-027</b> <b>0302-026</b> <b>0302-029</b></p> <p><b>0172-850</b></p>	
<p><b>19 Lifting device</b> To simplify the process of lifting the pump in and out of drums or containers. When using an explosion proof driving motor the Ex-protective plug is mounted onto the lifting device.</p> <p>for pump tube HD-E for B70V-SR with universal motor</p>	<p><b>0155-154</b> <b>0174-607</b></p>	